

View X
1 : 20

Isometric
1 : 100

Acc. to the installation manual,
the clamp position and the modules
have to be installed in a symmetrical
arrangement to the beam length.

14 modules (2x7 Portrait)
for module width ≤ 1155 mm

12 modules (2x6 Portrait)
for module width 1155-1303 mm

Peak velocity $q_p[z]$: 0.67kN/m²
Ground snow load S_k : 1.75kN/m²

	K2 Systems GmbH Haldenstr. 1 71272 Renningen Germany +49 7159 42059-0			Designation: Data sheet N-Rack 2.20 Pile 2x7 L	
	Name	Date	Material:	Item no.:	-
	Designed	C. Erb	28.01.2026	Surface:	-
	Approved	L. Kreemke	16.03.2026	Weight:	-
Last change			Scale:	1:50	A3
All dimensions in mm					
Sheet 1 of 1					

This drawing is the sole property of K2 Systems GmbH. It is protected by copyright and may only be copied, reproduced or distributed to a third party with explicit permission!

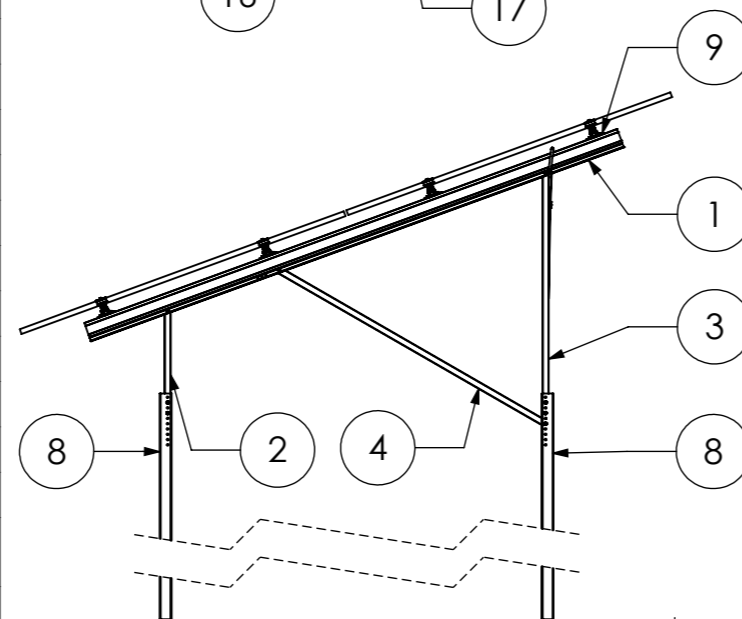
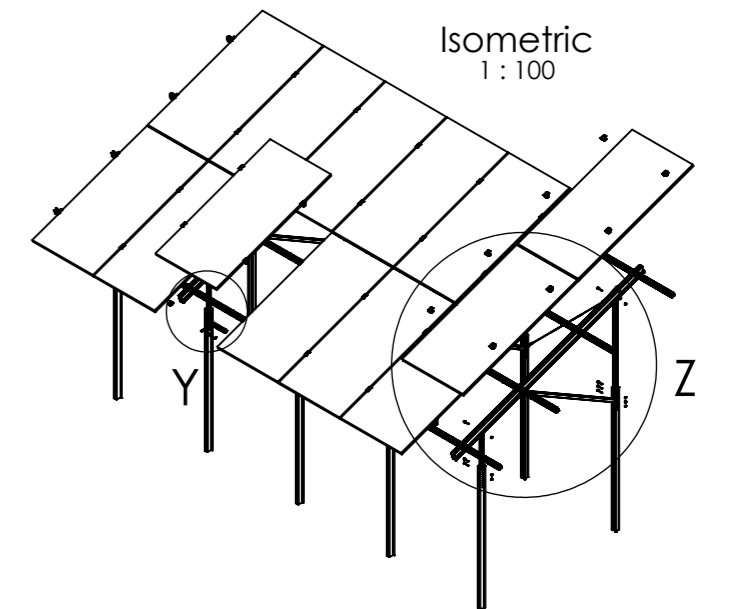
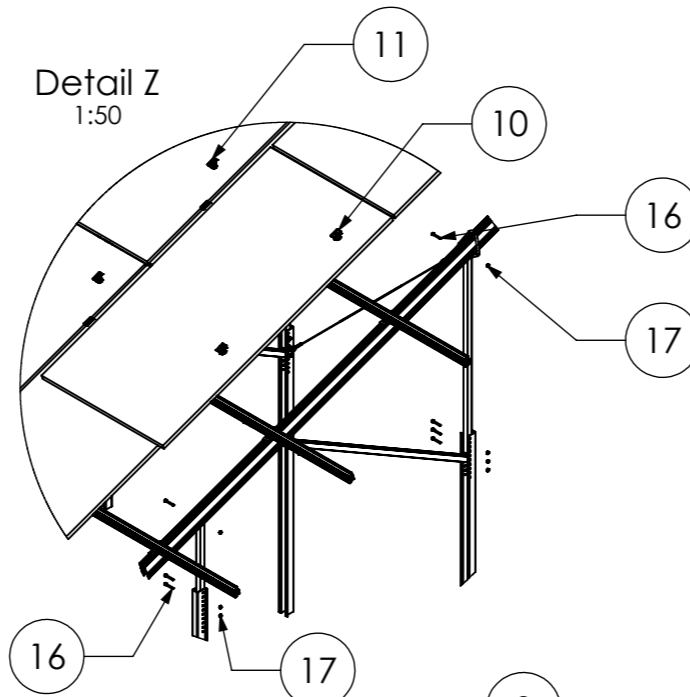
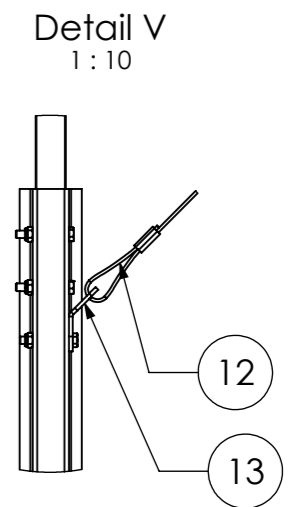
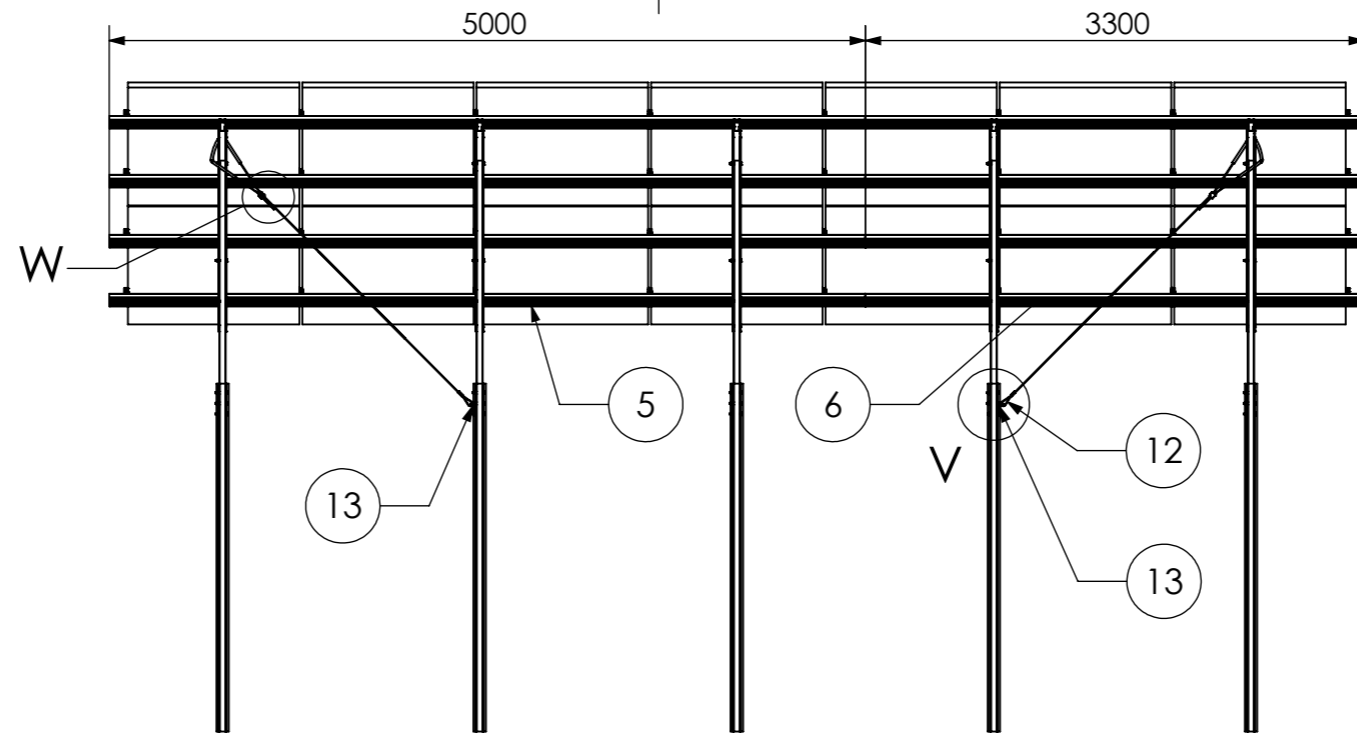
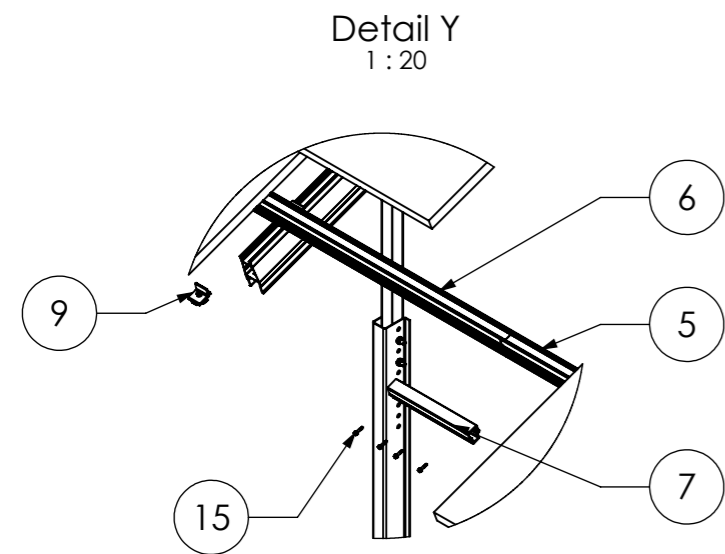
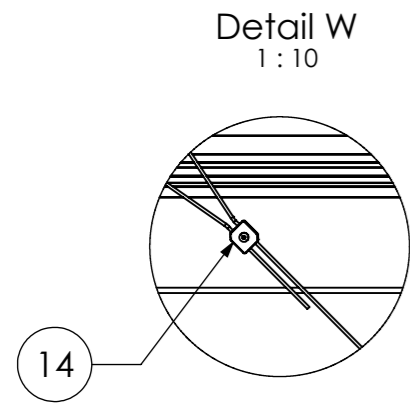

Pos.No.	Designation
1	Beam N-Rack 3750
2	3-Hole Brace N-Rack 715
3	3-Hole Brace N-Rack 1625
4	2-Hole Brace N-Rack 2072
5	CrossRail 73 - 5 m
6	CrossRail 73 - 3,3 m
7	CrossRail 73 Connector
8	Cap-Profile N-Rack
9	Climber 36/50 Set
10	EC Clamp Set
11	MC Clamp Set
12	Gripple Bracing
13	Gripple Angle
14	Gripper Lock
15	Self-tapping screw 5,5 x 25 - A2
16	Hexagon head bolt - ISO 4014 - M10x70-A2-70
17	Hexagon nut with clamping piece - ISO 10511 - M10 - A2-70

14 modules (2x7 Portrait)
for module width ≤ 1155 mm

12 modules (2x6 Portrait)
for module width 1155-1303 mm

Peak velocity $q_p[z]$: 0.67kN/m²
Ground snow load S_k : 1.75kN/m²

	K2 Systems GmbH Haldenstr. 1 71272 Renningen Germany +49 7159 42059-0			Designation: Data sheet N-Rack 2.20 Pile 2x7 L	
	Name	Date	Material:	Item no.:	A3
	Designed	C. Erb	28.01.2026	-	
	Approved	L. Kreemke	16.03.2026	Surface: -	Drawing no.: -
Last change			Weight: -	Scale: 1:50	All dimensions in mm Sheet 1 of 1

This drawing is the sole property of K2 Systems GmbH. It is protected by copyright and may only be copied, reproduced or distributed to a third party with explicit permission!